

LEAP FROG

by Bonnie Hunter Quiltmaker

What a great use for novelty prints—select lots of them and one common background fabric (pictured here in solid white) to make this fun quilt. You will learn how to make easy half-square triangles (HST) and use *Fons and Porter's Triangle Trimmers* which make sewing triangles to squares a breeze (no cut-off points)!



60" x 72" lap quilt

Leap Frog uses eighty 6" (finished) blocks set 8 blocks across by 10 blocks down.
Stand back and watch this quilt come to life!

Yardage and Cutting Chart

Use pre-washed 100% cotton fabrics—one white (or light) fabric throughout (either a solid or tone-on-tone) and a variety of different medium to dark novelty prints. Each block uses only two colors—white plus one medium to dark print. Try to use a variety of prints. A $\frac{1}{4}$ " seam allowance is included.

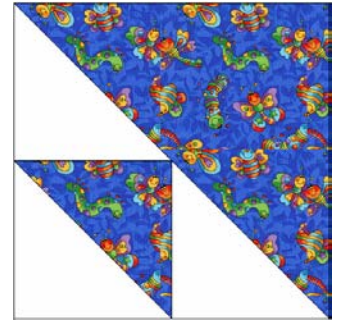

6" blocks (6 $\frac{1}{2}$ " unfinished)

BLOCKS

1 $\frac{1}{2}$ yds. solid white, white tone-on-tone or light:

CUT: (12) 3 $\frac{7}{8}$ " x width of fabric (WOF) strips;

subcut each strip into (10) 3 $\frac{7}{8}$ " squares for a total of (120) 3 $\frac{7}{8}$ " squares

set (40) 3 $\frac{7}{8}$ " squares aside for half-square triangles (HST) below

subcut (80) 3 $\frac{7}{8}$ " squares once on the diagonal to make 160 triangles

The equivalent of 2-3 yds. medium to dark novelty-prints (can use fat quarters or scraps):

CUT: (40) 6 $\frac{7}{8}$ " AND (40) 3 $\frac{7}{8}$ " squares:

You will need 1 large and 1 small square from the same print = one matching square set
(each matching square set will yield enough pieces for 2 blocks; you will need to cut (40) matching square sets from a variety of novelty print fabrics)

BORDER & BINDING

Border #1 $\frac{3}{4}$ yard white, same fabric as used in blocks; cut (7) 2 $\frac{1}{2}$ " x WOF

Border #2 1 yard print fabric; cut (7) 4 $\frac{1}{2}$ " x WOF strips

Binding $\frac{3}{4}$ yard your choice; cut (7) 2 $\frac{1}{2}$ " x WOF strips

Block Construction

Making Half-Square Triangles (HST)

You will use the "Un-Biased Solution" to make half-square triangle (HST) units. For each block, layer one 3 $\frac{7}{8}$ " white and one 3 $\frac{7}{8}$ " med. to dark squares, right sides together. On the wrong side of the lighter fabric, draw a diagonal pencil line and stitch $\frac{1}{4}$ " away on both sides of the line as illustrated here. Cut on the solid, center line and press seam toward darker fabric. Trim "dog ears." This makes two half-square triangles—one for this block and one for another block. They should each measure 3 $\frac{1}{2}$ " square. You will need a total of 80 HST.

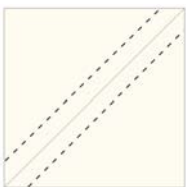

Using Fons & Porter's Triangle Trimmers

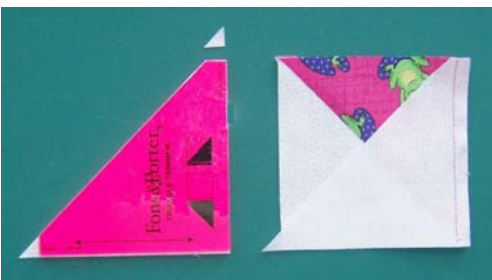

1. With right sides facing, lay 1 pre-cut white triangle atop the HST made above, aligning square corners. The triangle tip extends beyond the HST. To fit triangle exactly to the square, use the **pink** trimmer to trim one tip perpendicular to the short side of the triangle. Leave the other tip un-trimmed. Stitch the triangle to one side of the HST as shown.

2. Open out triangle and press seam allowances toward triangle. With right sides facing, lay the second triangle atop the joined pieces. Use the **blue** trimmer to trim one tip perpendicular to long side of triangle. Leave the other tip un-trimmed. Join the triangle to the adjacent side of HST. Open out triangle; press seam allowances toward white triangle. You will need a total of 80 units made in this manner.

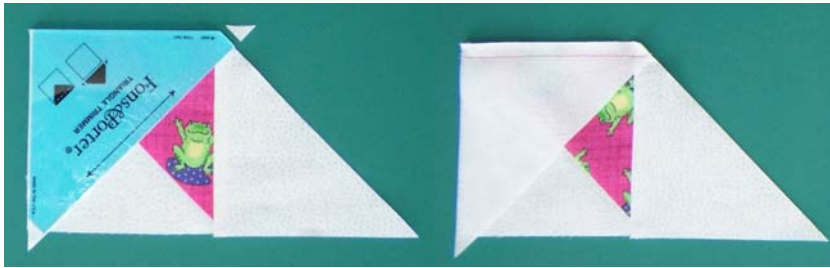

Note the $\frac{1}{4}$ " seam allowances between the corners of the small pink triangle and the raw edges of the triangle unit shown below. When assembled, there should be no cut-off points.

Completing the Block

Cut each of the (40) $6\frac{7}{8}$ " print squares once on the diagonal to make two triangles (for a total of 80 large triangles).

Matching the fabrics in the small and large triangles, sew a large triangle to a HST/triangle unit made above (with right sides together), sewing along the long side of the triangle. Stitch with the HST/triangle unit on top so you can see the stitched "x" made when the unit was pieced in step 2 above. Press toward larger triangle. Trim dog ears. The block should measure $6\frac{1}{2}$ ". Make 80 blocks in this manner, matching the fabric in the smaller and larger triangles.



Assembling the Quilt

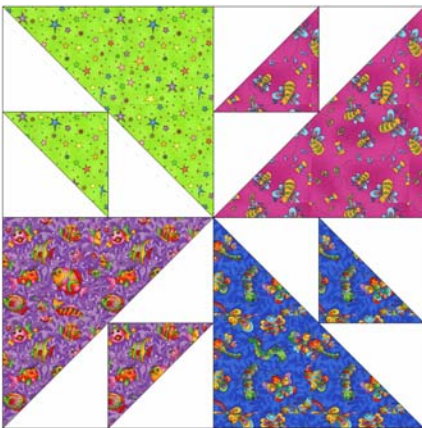

To make it a little easier to arrange blocks for the quilt top, you might want to assemble larger pinwheel blocks (left) using four Leap Frog blocks. Make 24 of these larger blocks and then set them in the same orientation—4 blocks across by 5 blocks down as shown on page 1.

Add borders, sewing side borders on first then top and bottom.

Layer top with backing and batting. Quilt as desired and bind using $2\frac{1}{2}$ " strips listed on page 2 to make French-fold (double) binding.



Creative Commons Copyright License 2008 Bonnie Hunter

Bonnie Hunter Quiltmaker patterns are released under a Creative Commons license. They're yours. Copy them as much as you want, pass 'em around. All I ask is that you don't alter or sell them and please leave my name on them.

